



Gg HRC Ceramic Fuse Types Blade 500VAC 120ka 50A 63A 80A 200A Knife Fuse Link and Base

Our Product Introduction

Basic Information

- Place of Origin: China
- Brand Name: Golden Electric /OEM
- Certification: ISO 9001, ISO 9000, ISO 14001, ISO 14000, ISO 20000, OHSAS/ OHSMS 18001, IATF16949
- Minimum Order Quantity: 1
- Packaging Details: Carton/Pallet
- Delivery Time: Peak Season Lead Time: more than 12 months Off Season Lead Time: within 15 workdays
- Payment Terms: LC, T/T, PayPal, Western Union
- Supply Ability: 5000/Month



Product Specification

- Material: Ceramic
- Rated Breaking Capacity: 120ka
- Rated Voltage: 690VAC 500VAC
- Operating Class: Gg Fuse
- Function: Overcurrent Protection
- Model: Low Voltage Fuse
- Current: Up To 1250A
- Transport Package: Standard Export Carton
- Specification: 125A/160A/250A/400A/630A
- Trademark: Golden Or Natural, Or Customer Brand
- Origin: China
- Supply Ability: 20000PCS/Month
- Breaking Capacity: High
- Type: Current Fuse
- Usage: Low Voltage



More Images



for more products please visit us on chinagoldene.com

Product Description

Product Description

NH/NT Blade type fuse-links aM class are for motor protection. These high breaking capacity fuse-links are intended for short circuit protection in motors, transformer and other load with high inrush current. There is a standard visual indicator on the top end, and an optional on the front side. This series fuses comprises fuses from size NH000 up to NH4, with rated currents up to 1250A, rated voltage up to 690V.

Application

Industrial fuse links for a wide variety of applications.

Product Features



Dual indication
Low temperature rise
Globally compliant

High breaking capacity
Reliable dual indicator system
IEC 60269-1 and 2, DIN 43620

Product Parameters

Model Number	NH000 NH00 NH0 NH1 NH2 NH3 NH4
Voltage	690Vac 500Vac
Current	Up to 1250A
Breaking Capacity	120kA
Operating class	gG Fuse
Standards	GB13539.1/2 IEC 60269-1/-2
Country of Origin	China

Product Details

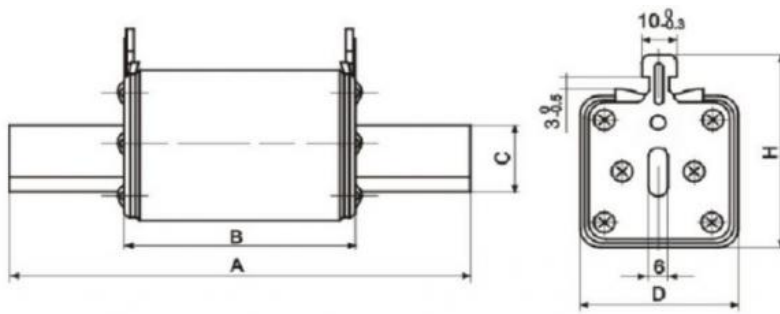

Model	Rated voltage (Vac)	Rated current (A)	Dimension A B C D H
NH00C/NH00C	500/690	4-160	78 52 152 153
NH00/NH00	500/690	4-160	78 53 153 060
NH0/NH0	500/690	6-160	125 67 153 060
NH1/NH1	500/690	32-250	135 72 204 865
NH2/NH2	500/690	80-400	150 72 255 872
NH3/NH3	500/690	160-630	150 74 326 782

Recommand Product



Company Profile

- Golden Electric Co.,Ltd ,was foundad in 2007, we are professional for make AC and DC electric items such as cable gland,MC4 Connector, isolator switch , fuse , breaker , distribution box , PV combiner box ,surge protector, Indicator lamp,Solar Charge Controller,Industrial plug and socket,Busbar Insulator,Meter Socket,Wind Turbine, Terminal Block,Solar product and so on.

- Golden has been granted ISO9001 management system certifications. The comprehensive product line has more than 1000 models which have been approved by TUV,CE,CQC,SGS,ROHS,SASO. The productsells well to UK, Spain, Portugal, Singapore, Turkey, Russia, Korea, South Africa... more than 60 countries and regions.

- Golden is always striving hard to provide the best services and competitive price to all customers.

FAQ

1) Q:How can i trust your company?

A:Golden electric is The top 10 manufacture in China - more than 350 Agents in local market and more than 100 foreign clients make OEM,ODM order from us,Golden electric is a big company, we have cooperation with LS, EKF the world-class companies. Our company over 100 employees, products pass CE,IEC,TUV,SAA, RCM, ROHS certificates.

2) Q:Your products?

A: Golden electric is factory for Automatic transfer swithc,Surge protector device,distribution box Enclosure, inverter, DC fuse etc. Providing customers very competitive sources, and can be your sourcing agent in China. Goods are following international standards, IE, CE, ISO9001 ,SGS etc.

3) Q:What standars is the main reference for using fuses in European countries?

A:IEC 60269

4) Q:What factors will affect the breaking capacity?

A: AC/DC Voltage, shot current levels.

5) Q: What factors will affect the overload capability?

A: Pre-loading, cyclic loading surges,manufacturing tolerances.

6) Q: Do you have forwarder?

A: Yes, we have good forwarder cooperated over 10 years, they help us import and export . For small package orders, suggest to use by Express.

7) Q: Your address ?

A: Locates in Guangzhou province, China,welcome to visit us

8) Q:What's the Industrial Plug and Socket Distribution Box guarantee?

A: 2 years warranty. If customer's problem, then customer burden. If our problem, then we send new goods to customer to replace asap.

9) Q:What's about MOQ? Delivery time ?

A: 1pcs for Industrial plug and socket distribution Box.

10) Q: What's the payment term?

A: Normally 100% T/T in advanced payment. If big order then about 50% advanced payment, balance before shipment.PAYPAL,WESTERN UNION,CASH for small order .

11) Q:What's your contact information ?

Send us your [inquiry](#) !we will reply you in 24 hours !

If you need information about this product. Please [Click here](#) to contact me and we will provide you with more information about the products.



Guangzhou Golden Electric Co., Ltd.



008618998498109



eva@china-golden.com.cn



chinagoldene.com

Building 4, Self-edited Building, No. 728, Kaichuang Avenue, Yunpu Industrial Zone, Huangpu District, Guangzhou city, Guangdong province, China