



Customization M8 Brass Insert Low Voltage Busbar Support Plastic Standoff Insulator SM30

Our Product Introduction

Basic Information

- Place of Origin: China
- Brand Name: Golden Electric /OEM
- Certification: ISO 9001, ISO 9000, ISO 14001, ISO 14000, ISO 20000, OHSAS/ OHSMS 18001, IATF16949
- Minimum Order Quantity: 1
- Packaging Details: Carton/Pallet
- Delivery Time: Peak Season Lead Time: more than 12 months Off Season Lead Time: within 15 workdays
- Payment Terms: LC, T/T, PayPal, Western Union
- Supply Ability: 5000/Month



Product Specification

- Size Of Bearing Capacity: 100KN
- Color: Red Or Black
- Brand: Golden Electric/OEM
- Model No.: Sm30
- Operating Temperature: -40~+140
- Material Of The Product: Bough Moulding Compound(BMC) SMC
- Tensile Strenth(Lbs): 400
- Torque Strength(Ftlbs): 6
- Product Name: Bus-Bar Insulator
- Color Details: Insert ,Material Accordance With Customer Needs
- Voltage Withstand(Kv): 6
- Screw Depth(mm): 6-10mm
- Warranty: 2years
- Insert: Brass,Steel With Zn Coating



More Images



for more products please visit us on chinagoldene.com

Product Description

High Quality SM Series Bus Bar Insulator Busbar Insulator Standoff Insulator



Golden Electric



SM系列产品

SM 绝缘子系列 Insulator Series

型号及含义 Type and Meaning



产品性能 Product performance

工作温度: $-40^{\circ}\text{C} \sim +140^{\circ}\text{C}$;
螺母: 黄铜、铁;
材料: 不饱和聚酯树脂玻璃纤维增强塑料(BMC)(SMC);
颜色、嵌件、材料性能可依客户需求定制。
安装螺丝(附件选配)
Operating temperature: $-40 \sim 140$;
Nuts: brass, iron;
Material: unsaturated polyester tree glass fiber reinforced compressive plastics (BMC) (SMC);
The color, insert and material properties can be customized according to customer requirements.
Installation screw (accessory selection)



SM-20绝缘端子
Insulated terminal

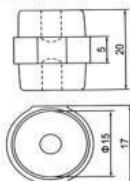

镀(嵌)件 Mosaic		绝缘性能 Insulation property	
螺母规格 Nut specification	M5/M6	绝缘电阻 insulation resistance	300mΩ
螺孔深度 Screw hole depth	7mm	电性能 Electrical properties	
螺母材料 Nut material	铜copper	工作电压 working voltage	600V
强度 Strength		脉冲电压 Pulse voltage	3000V
轴向抗拉 Axial tension	500N	漏电流在2000V的工作电压下 Leakage current at 2000 V Working Voltage	<1mA
抗弯 Bending resistance	1000N	耐压 Withstand voltage	5kv
拧紧力矩 Tightening torque	8N/m		

SM-25绝缘端子
Insulated terminal

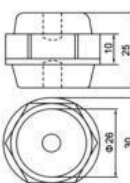

镀(嵌)件 Mosaic		绝缘性能 Insulation property	
螺母规格 Nut specification	M5/M6	绝缘电阻 insulation resistance	500mΩ
螺孔深度 Screw hole depth	9mm	电性能 Electrical properties	
螺母材料 Nut material	铜copper	工作电压 working voltage	600V
强度 Strength		脉冲电压 Pulse voltage	3000V
轴向抗拉 Axial tension	2000N	漏电流在2000V的工作电压下 Leakage current at 2000 V Working Voltage	<1mA
抗弯 Bending resistance	3000N	耐压 Withstand voltage	6kv
拧紧力矩 Tightening torque	10N/m		

SM-25S绝缘端子
Insulated terminal

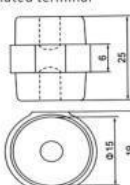

镀(嵌)件 Mosaic		绝缘性能 Insulation property	
螺母规格 Nut specification	M6	绝缘电阻 insulation resistance	300mΩ
螺孔深度 Screw hole depth	9mm	电性能 Electrical properties	
螺母材料 Nut material	铜copper	工作电压 working voltage	600V
强度 Strength		脉冲电压 Pulse voltage	3000V
轴向抗拉 Axial tension	800N	漏电流在2000V的工作电压下 Leakage current at 2000 V Working Voltage	<1mA
抗弯 Bending resistance	2000N	耐压 Withstand voltage	5kv
拧紧力矩 Tightening torque	8N/m		

SM 绝缘子系列 Insulator Series

型号及含义 Type and Meaning



产品性能 Product performance

工作温度：-40℃~+140℃；
螺母：黄铜、铁；
材料：不饱和聚酯树脂玻璃纤维增强压塑料(BMC)(SMC)；
颜色、嵌件、材料性能可依客户需求定制。
安装螺丝(附件选配)
Operating temperature: -40~140;
Nuts: brass, iron;
Material: unsaturated polyester tree glass fiber reinforced compressive plastics (BMC) (SMC);
The color, insert and material properties can be customized according to customer requirements.
Installation screw (accessory selection)

SM-30绝缘端子
Insulated terminal

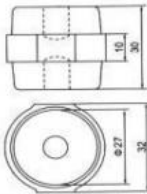

镶 (嵌) 件 Mosaic		绝缘性能 Insulation property	
螺母规格Nut specification	M6/M8	绝缘电阻 insulation resistance	500mΩ
螺孔深度Screw hole depth	9mm/10mm	电性能 Electrical properties	
螺母材料Nut material	铜copper	工作电压working voltage	600V
强度 Strength		脉冲电压Pulse voltage	3000V
轴向抗拉Axial tension	2000N	漏电流在2000V的工作电压下 Leakage current at 2000 VWorking Voltage	<1mA
抗弯Bending resistance	4000N	耐压 Withstand voltage	8kv
拧紧力矩Tightening torque	10N/m		

SM-35绝缘端子
Insulated terminal

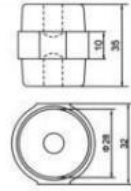

镶 (嵌) 件 Mosaic		绝缘性能 Insulation property	
螺母规格Nut specification	M6/M8	绝缘电阻 insulation resistance	>500mΩ
螺孔深度Screw hole depth	10mm/10mm	电性能 Electrical properties	
螺母材料Nut material	铜copper	工作电压working voltage	600V
强度 Strength		脉冲电压Pulse voltage	5000V
轴向抗拉Axial tension	300N	漏电流在2000V的工作电压下 Leakage current at 2000 VWorking Voltage	<1mA
抗弯Bending resistance	4000N	耐压 Withstand voltage	10kv
拧紧力矩Tightening torque	12N/m		

SM-40绝缘端子
Insulated terminal

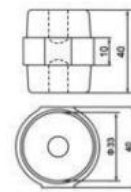

镶 (嵌) 件 Mosaic		绝缘性能 Insulation property	
螺母规格Nut specification	M8/M10	绝缘电阻 insulation resistance	>1500mΩ
螺孔深度Screw hole depth	10.5mm/13.5mm	电性能 Electrical properties	
螺母材料Nut material	铜copper	工作电压working voltage	600V
强度 Strength		脉冲电压Pulse voltage	5000V
轴向抗拉Axial tension	3000N	漏电流在2000V的工作电压下 Leakage current at 2000 VWorking Voltage	<1mA
抗弯Bending resistance	5000N	耐压 Withstand voltage	10kv
拧紧力矩Tightening torque	15N/m		

SM 绝缘子系列 Insulator Series

●型号及含义 Type and Meaning



●产品性能 Product performance

工作温度：-40℃~+140℃；
螺母：黄铜、铁；
材料：不饱和聚酯树脂玻璃纤维增强塑料(BMC)(SMC)；
颜色、嵌件、材料性能可依客户需求定制。
安装螺丝(附件选配)
Operating temperature: - 40 ~ 140;
Nuts: brass, iron;
Material: unsaturated polyester tree glass fiber reinforced compressive plastics (BMC) (SMC);
The color, insert and material properties can be customized according to customer requirements.
Installation screw (accessory selection)



SM-45绝缘端子
Insulated terminal

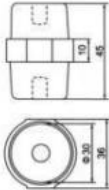

镶 (嵌) 件 Mosaic		绝缘性能 Insulation property	
螺母规格Nut specification	8M/M10	绝缘电阻 insulation resistance	>1000mΩ
螺孔深度Screw hole depth	10.5/13.5mm	电性能 Electrical properties	
螺母材料Nut material	铜copper	工作电压working voltage	600V
强度 Strength		脉冲电压Pulse voltage	5000V
轴向抗拉Axial tension	4000N	漏电流在2000V的工作电压下 Leakage current at 2000 VWorking Voltage	<1mA
抗弯Bending resistance	5500N		
拧紧力矩Tightening torque	15N/m	耐压 Withstand voltage	10kv

SM-51绝缘端子
Insulated terminal

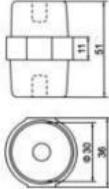

镶 (嵌) 件 Mosaic		绝缘性能 Insulation property	
螺母规格Nut specification	M8/M10	绝缘电阻 insulation resistance	>1000mΩ
螺孔深度Screw hole depth	10.5/13.5mm	电性能 Electrical properties	
螺母材料Nut material	铜copper	工作电压working voltage	600V
强度 Strength		脉冲电压Pulse voltage	5000V
轴向抗拉Axial tension	300N	漏电流在2000V的工作电压下 Leakage current at 2000 VWorking Voltage	<1mA
抗弯Bending resistance	5000N		
拧紧力矩Tightening torque	15N/m	耐压 Withstand voltage	12kv

SM-60绝缘端子
Insulated terminal

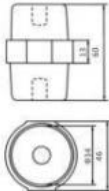

镶 (嵌) 件 Mosaic		绝缘性能 Insulation property	
螺母规格Nut specification	M10	绝缘电阻 insulation resistance	>1000mΩ
螺孔深度Screw hole depth	13.5mm	电性能 Electrical properties	
螺母材料Nut material	铜copper	工作电压working voltage	600V
强度 Strength		脉冲电压Pulse voltage	5000V
轴向抗拉Axial tension	300N	漏电流在2000V的工作电压下 Leakage current at 2000 VWorking Voltage	<1mA
抗弯Bending resistance	5000N		
拧紧力矩Tightening torque	15N/m	耐压 Withstand voltage	20kv

SM 绝缘子系列 Insulator Series



●型号及含义 Type and Meaning

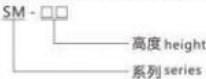

●产品性能 Product performance

工作温度: $-40^{\circ}\text{C} \sim +140^{\circ}\text{C}$;
螺母: 黄铜、铁;
材料: 不饱和聚酯树脂玻璃纤维增强抗压塑料(BMC)(SMC);
颜色、嵌件、材料性能可依客户需求定制。
安装螺丝(附件选配)
Operating temperature: $-40 \sim 140$;
Nuts: brass, iron;
Material: unsaturated polyester tree glass fiber reinforced compressive plastics (BMC) (SMC);
The color, insert and material properties can be customized according to customer requirements.
Installation screw (accessory selection)

SM-76绝缘端子
Insulated terminal

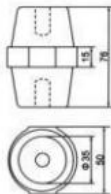

镶 (嵌) 件 Mosaic	
螺母规格Nut specification	M10
螺孔深度Screw hole depth	13.5mm
螺母材料Nut material	铜copper
强度 Strength	
轴向抗拉Axial tension	4000N
抗弯Bending resistance	5000N
拧紧力矩Tightening torque	20N/m

绝缘性能 Insulation property	
绝缘电阻 insulation resistance	>1500mΩ
电性能 Electrical properties	
工作电压working voltage	1500V
脉冲电压Pulse voltage	10000V
漏电流在2000V的工作电压下 Leakage current at 2000 VWorking Voltage	<1mA
耐压 Withstand voltage	25kv

SM-100绝缘端子
Insulated terminal

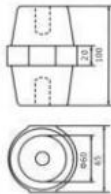

镶 (嵌) 件 Mosaic	
螺母规格Nut specification	M10
螺孔深度Screw hole depth	13.5mm
螺母材料Nut material	铜copper
强度 Strength	
轴向抗拉Axial tension	4000N
抗弯Bending resistance	5000N
拧紧力矩Tightening torque	20N/m

绝缘性能 Insulation property	
绝缘电阻 insulation resistance	>1500mΩ
电性能 Electrical properties	
工作电压working voltage	1500V
脉冲电压Pulse voltage	10000V
漏电流在2000V的工作电压下 Leakage current at 2000 VWorking Voltage	<1mA
耐压 Withstand voltage	25kv

SM-7105绝缘端子
Insulated terminal

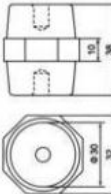

镶 (嵌) 件 Mosaic	
螺母规格Nut specification	M6/M8
螺孔深度Screw hole depth	10/13.5mm
螺母材料Nut material	铜copper
强度 Strength	
轴向抗拉Axial tension	4000N
抗弯Bending resistance	5000N
拧紧力矩Tightening torque	12N/m

绝缘性能 Insulation property	
绝缘电阻 insulation resistance	>1500mΩ
电性能 Electrical properties	
工作电压working voltage	1500V
脉冲电压Pulse voltage	10000V
漏电流在2000V的工作电压下 Leakage current at 2000 VWorking Voltage	<1mA
耐压 Withstand voltage	25kv

A: Depends on your request, we have standard models in stock. Some special product and big order will be newly produced according to your order.

Q: Can I mixed different type in one container?

A: Yes,different models can be mixed up in one container,even one order.

Q: How does your factory do the quality control?

A: Quality is priority,we always attach the importance to quality control from the beginning to the end of the production.Every product will be fully assembled and carefully tested before packing and shipping.



Guangzhou Golden Electric Co., Ltd.



008618998498109



eva@china-golden.com.cn



chinagoldene.com

Building 4, Self-edited Building, No. 728, Kaichuang Avenue, Yunpu Industrial Zone, Huangpu District,
Guangzhou city,Guangdong province,China