



BMC/SMC Copper Insulators Busbar Insulator Sm Type Polymer Electrical Standoff Bus Bar

Our Product Introduction

Basic Information

- Place of Origin: China
- Brand Name: Golden Electric /OEM
- Certification: ISO 9001, ISO 9000, ISO 14001, ISO 14000, ISO 20000, OHSAS/ OHSMS 18001, IATF16949
- Minimum Order Quantity: 1
- Packaging Details: Carton/Pallet
- Delivery Time: Peak Season Lead Time: more than 12 months
Off Season Lead Time: within 15 workdays
- Payment Terms: LC, T/T, PayPal, Western Union
- Supply Ability: 5000/Month



Product Specification

- Color: Red Or Black
- Brand: Golden Electric /OEM
- Insert: Copper ,Steel With Zn Coating
- Working Voltage: 600V
- Pulse Voltage: 5000V
- Insulation Resistance: 500mΩ
- Screw Depth(mm): 6-10mm
- Operating Temperature: -40~+140
- Product Name: Low Voltage Busbar Insulator
- Warranty: 2 Years
- Model No.: Sm Series
- Transport Package: Standard Export Carton
- Specification: SM25 SM30 SM35 SM40 SM51 SM76
- Trademark: Golden Or Natural, Or Customer Brand
- Origin: China



More Images



for more products please visit us on chinagoldene.com

Product Description

Product Description

Bsubar insulators are made from flame retardant fiberglass reinforced polyester and are stronger and hold closer tolerances than the traditional porcelain insulators. Our range of stand-off insulators isolates electrical conductors from mechanical mounting, preventing short circuits, Combine high mechanical strength with high arc resistance.

Insulator is the special part to fix,install and insulat on communication, electric power, lightning protection, machinery, medical, wind energy, frequency conversion equipment,new energy vehicles (integrated chassis cabinets, locker, etc.) to provide meet the fixed support, installation and insulation isolation effect of special parts, it is also known as insulators, insulation column .Its appearance is usually the cylinder,hexagonal,round.There is the insert on the two surface of insulator.

Product Parameters

| Item | Tensile strength (LBS) | Torgue Strength (FT LBS) | Voltage withstand (KV) | Screw (mm) | Screw Depth |
|--------|---------------------------|-----------------------------|---------------------------|---------------|----------------|
| SM-20 | 300 | 4 | 5 | M5 | 7mm |
| SM-25S | 400 | 5 | 6 | M6 | 8mm |
| SM-25 | 500 | 6 | 6 | M6 | 9mm |
| SM-30 | 550 | 8 | 8 | M6 | 11mm |
| SM-35 | 600 | 10 | 10 | M8 | 11mm |
| SM-40 | 650 | 12 | 12 | M8 | 11mm |
| SM-45 | 1000 | 20 | 14 | M8 | 11mm |
| SM-51 | 1000 | 20 | 15 | M8 | 14mm |
| SM-60 | 1200 | 40 | 25 | M10 | 20mm |
| SM-76 | 1500 | 40 | 25 | M10 | 20mm |

SM 绝缘子系列 Insulator Series



●型号及含义 Type and Meaning



●产品性能 Product performance

工作温度：-40℃~+140℃；
螺母：黄铜、铁；
材料：不饱和聚酯树脂玻璃纤维增强压塑料(BMC)(SMC)；
颜色、嵌件、材料性能可依客户需求定制。
安装螺丝(附件选配)
Operating temperature: -40~140;
Nuts: brass, iron;
Material: unsaturated polyester tree glass fiber reinforced compressive plastics (BMC) (SMC);
The color, insert and material properties can be customized according to customer requirements.
Installation screw (accessory selection)

SM-20绝缘端子
Insulated terminal

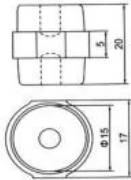

| 镶（嵌）件 Mosaic | |
|-----------------------|---------|
| 螺母规格Nut specification | M5/M6 |
| 螺孔深度Screw hole depth | 7mm |
| 螺母材料Nut material | 铜copper |
| 强度 Strength | |
| 轴向抗拉Axial tension | 500N |
| 抗弯Bending resistance | 1000N |
| 拧紧力矩Tightening torque | 8N/m |

| 绝缘性能 Insulation property | |
|---|-------|
| 绝缘电阻 insulation resistance | 300mΩ |
| 电性能 Electrical properties | |
| 工作电压working voltage | 600V |
| 脉冲电压Pulse voltage | 3000V |
| 漏电流在2000V的工作电压下 Leakage current at 2000 VWorking Voltage | <1mA |
| 耐压 Withstand voltage | 5kv |

SM-25绝缘端子
Insulated terminal

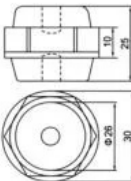

| 镶（嵌）件 Mosaic | |
|-----------------------|---------|
| 螺母规格Nut specification | M5/M6 |
| 螺孔深度Screw hole depth | 9mm |
| 螺母材料Nut material | 铜copper |
| 强度 Strength | |
| 轴向抗拉Axial tension | 2000N |
| 抗弯Bending resistance | 3000N |
| 拧紧力矩Tightening torque | 10N/m |

| 绝缘性能 Insulation property | |
|---|-------|
| 绝缘电阻 insulation resistance | 500mΩ |
| 电性能 Electrical properties | |
| 工作电压working voltage | 600V |
| 脉冲电压Pulse voltage | 3000V |
| 漏电流在2000V的工作电压下 Leakage current at 2000 VWorking Voltage | <1mA |
| 耐压 Withstand voltage | 6kv |

SM-25S绝缘端子
Insulated terminal

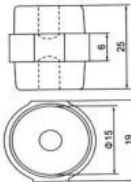

| 镶（嵌）件 Mosaic | |
|-----------------------|---------|
| 螺母规格Nut specification | M6 |
| 螺孔深度Screw hole depth | 9mm |
| 螺母材料Nut material | 铜copper |
| 强度 Strength | |
| 轴向抗拉Axial tension | 800N |
| 抗弯Bending resistance | 2000N |
| 拧紧力矩Tightening torque | 8N/m |

| 绝缘性能 Insulation property | |
|---|-------|
| 绝缘电阻 insulation resistance | 300mΩ |
| 电性能 Electrical properties | |
| 工作电压working voltage | 600V |
| 脉冲电压Pulse voltage | 3000V |
| 漏电流在2000V的工作电压下 Leakage current at 2000 VWorking Voltage | <1mA |
| 耐压 Withstand voltage | 5kv |

SM 绝缘子系列 Insulator Series



型号及含义 Type and Meaning



产品性能 Product performance

工作温度: -40℃~+140℃;
螺母: 黄铜、铁;
材料: 不饱和聚酯树脂玻璃纤维增强压塑料(BMC)(SMC);
颜色、嵌件、材料性能可依客户需求定制。
安装螺丝(附件选配)
Operating temperature: -40~140;
Nuts: brass, iron;
Material: unsaturated polyester tree glass fiber reinforced compressive plastics (BMC) (SMC);
The color, insert and material properties can be customized according to customer requirements.
Installation screw (accessory selection)

SM-30绝缘端子
Insulated terminal

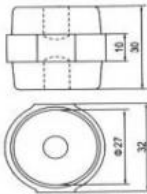

| 镶 (嵌) 件 Mosaic | | 绝缘性能 Insulation property | |
|-----------------------|----------|---|-------|
| 螺母规格Nut specification | M6/M8 | 绝缘电阻 insulation resistance | 500mΩ |
| 螺孔深度Screw hole depth | 9mm/10mm | 电性能 Electrical properties | |
| 螺母材料Nut material | 铜copper | 工作电压working voltage | 600V |
| 强度 Strength | | 脉冲电压Pulse voltage | 3000V |
| 轴向抗拉Axial tension | 2000N | 漏电流在2000V的工作电压下 Leakage current at 2000 VWorking Voltage | <1mA |
| 抗弯Bending resistance | 4000N | | |
| 拧紧力矩Tightening torque | 10N/m | 耐压 Withstand voltage | 8kv |

SM-35绝缘端子
Insulated terminal

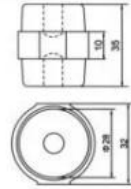

| 镶 (嵌) 件 Mosaic | | 绝缘性能 Insulation property | |
|-----------------------|-----------|---|--------|
| 螺母规格Nut specification | M6/M8 | 绝缘电阻 insulation resistance | >500mΩ |
| 螺孔深度Screw hole depth | 10mm/10mm | 电性能 Electrical properties | |
| 螺母材料Nut material | 铜copper | 工作电压working voltage | 600V |
| 强度 Strength | | 脉冲电压Pulse voltage | 5000V |
| 轴向抗拉Axial tension | 300N | 漏电流在2000V的工作电压下 Leakage current at 2000 VWorking Voltage | <1mA |
| 抗弯Bending resistance | 4000N | | |
| 拧紧力矩Tightening torque | 12N/m | 耐压 Withstand voltage | 10kv |

SM-40绝缘端子
Insulated terminal

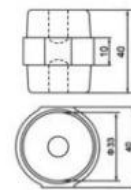

| 镶 (嵌) 件 Mosaic | | 绝缘性能 Insulation property | |
|-----------------------|---------------|---|---------|
| 螺母规格Nut specification | M8/M10 | 绝缘电阻 insulation resistance | >1500mΩ |
| 螺孔深度Screw hole depth | 10.5mm/13.5mm | 电性能 Electrical properties | |
| 螺母材料Nut material | 铜copper | 工作电压working voltage | 600V |
| 强度 Strength | | 脉冲电压Pulse voltage | 5000V |
| 轴向抗拉Axial tension | 3000N | 漏电流在2000V的工作电压下 Leakage current at 2000 VWorking Voltage | <1mA |
| 抗弯Bending resistance | 5000N | | |
| 拧紧力矩Tightening torque | 15N/m | 耐压 Withstand voltage | 10kv |

SM 绝缘子系列 Insulator Series

●型号及含义 Type and Meaning



●产品性能 Product performance

工作温度：-40℃~+140℃；
螺母：黄铜、铁；
材料：不饱和聚酯树脂玻璃纤维增强压塑料(BMC)(SMC)；
颜色、嵌件、材料性能可依客户需求定制。
安装螺丝(附件选配)
Operating temperature: - 40 ~ 140;
Nuts: brass, iron;
Material: unsaturated polyester tree glass fiber reinforced compressive plastics (BMC) (SMC);
The color, insert and material properties can be customized according to customer requirements.
Installation screw (accessory selection)



SM-45绝缘端子
Insulated terminal

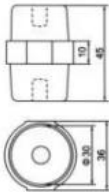

| 锁 (嵌) 件 Mosaic | | 绝缘性能 Insulation property | |
|-----------------------|-------------|---|---------|
| 螺母规格Nut specification | 8M/M10 | 绝缘电阻 insulation resistance | >1000mΩ |
| 螺孔深度Screw hole depth | 10.5/13.5mm | 电性能 Electrical properties | |
| 螺母材料Nut material | 铜copper | 工作电压working voltage | 600V |
| 强度 Strength | | 脉冲电压Pulse voltage | 5000V |
| 轴向抗拉Axial tension | 4000N | 漏电流在2000V的工作电压下 Leakage current at 2000 VWorking Voltage | <1mA |
| 抗弯Bending resistance | 5500N | | |
| 拧紧力矩Tightening torque | 15N/m | 耐压 Withstand voltage | 10kv |

SM-51绝缘端子
Insulated terminal

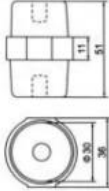

| 锁 (嵌) 件 Mosaic | | 绝缘性能 Insulation property | |
|-----------------------|-------------|---|---------|
| 螺母规格Nut specification | M8/M10 | 绝缘电阻 insulation resistance | >1000mΩ |
| 螺孔深度Screw hole depth | 10.5/13.5mm | 电性能 Electrical properties | |
| 螺母材料Nut material | 铜copper | 工作电压working voltage | 600V |
| 强度 Strength | | 脉冲电压Pulse voltage | 5000V |
| 轴向抗拉Axial tension | 300N | 漏电流在2000V的工作电压下 Leakage current at 2000 VWorking Voltage | <1mA |
| 抗弯Bending resistance | 5000N | | |
| 拧紧力矩Tightening torque | 15N/m | 耐压 Withstand voltage | 12kv |

SM-60绝缘端子
Insulated terminal

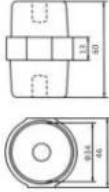

| 锁 (嵌) 件 Mosaic | | 绝缘性能 Insulation property | |
|-----------------------|---------|---|---------|
| 螺母规格Nut specification | M10 | 绝缘电阻 insulation resistance | >1000mΩ |
| 螺孔深度Screw hole depth | 13.5mm | 电性能 Electrical properties | |
| 螺母材料Nut material | 铜copper | 工作电压working voltage | 600V |
| 强度 Strength | | 脉冲电压Pulse voltage | 5000V |
| 轴向抗拉Axial tension | 300N | 漏电流在2000V的工作电压下 Leakage current at 2000 VWorking Voltage | <1mA |
| 抗弯Bending resistance | 5000N | | |
| 拧紧力矩Tightening torque | 15N/m | 耐压 Withstand voltage | 20kv |

SM 绝缘子系列 Insulator Series



•型号及含义 Type and Meaning



•产品性能 Product performance

工作温度：-40℃~+140℃；
螺母：黄铜、铁；
材料：不饱和聚酯树脂玻璃纤维增强塑料(BMC)(SMC)；
颜色、嵌件、材料性能可依客户需求定制。
安装螺丝(附件选配)
Operating temperature: -40~140;
Nuts: brass, iron;
Material: unsaturated polyester tree glass fiber reinforced compressive plastics (BMC) (SMC);
The color, insert and material properties can be customized according to customer requirements.
Installation screw (accessory selection)

SM-76绝缘端子
Insulated terminal

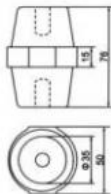

| 镶（嵌）件 Mosaic | |
|-----------------------|---------|
| 螺母规格Nut specification | M10 |
| 螺孔深度Screw hole depth | 13.5mm |
| 螺母材料Nut material | 铜copper |
| 强度 Strength | |
| 轴向抗拉Axial tension | 4000N |
| 抗弯Bending resistance | 5000N |
| 拧紧力矩Tightening torque | 20N/m |

| 绝缘性能 Insulation property | |
|---|---------|
| 绝缘电阻 insulation resistance | >1500mΩ |
| 电性能 Electrical properties | |
| 工作电压working voltage | 1500V |
| 脉冲电压Pulse voltage | 10000V |
| 漏电流在2000V的工作电压下 Leakage current at 2000 VWorking Voltage | <1mA |
| 耐压 Withstand voltage | 25kv |

SM-100绝缘端子
Insulated terminal

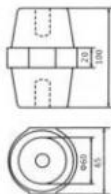

| 镶（嵌）件 Mosaic | |
|-----------------------|---------|
| 螺母规格Nut specification | M10 |
| 螺孔深度Screw hole depth | 13.5mm |
| 螺母材料Nut material | 铜copper |
| 强度 Strength | |
| 轴向抗拉Axial tension | 4000N |
| 抗弯Bending resistance | 5000N |
| 拧紧力矩Tightening torque | 20N/m |

| 绝缘性能 Insulation property | |
|---|---------|
| 绝缘电阻 insulation resistance | >1500mΩ |
| 电性能 Electrical properties | |
| 工作电压working voltage | 1500V |
| 脉冲电压Pulse voltage | 10000V |
| 漏电流在2000V的工作电压下 Leakage current at 2000 VWorking Voltage | <1mA |
| 耐压 Withstand voltage | 25kv |

SM-7105绝缘端子
Insulated terminal

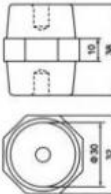

| 镶（嵌）件 Mosaic | |
|-----------------------|-----------|
| 螺母规格Nut specification | M6/M8 |
| 螺孔深度Screw hole depth | 10/13.5mm |
| 螺母材料Nut material | 铜copper |
| 强度 Strength | |
| 轴向抗拉Axial tension | 4000N |
| 抗弯Bending resistance | 5000N |
| 拧紧力矩Tightening torque | 12N/m |

| 绝缘性能 Insulation property | |
|---|---------|
| 绝缘电阻 insulation resistance | >1500mΩ |
| 电性能 Electrical properties | |
| 工作电压working voltage | 1500V |
| 脉冲电压Pulse voltage | 10000V |
| 漏电流在2000V的工作电压下 Leakage current at 2000 VWorking Voltage | <1mA |
| 耐压 Withstand voltage | 25kv |

Product Features



Material

Made of high quality molded unsaturated polyester glass fiber resin force plastic(BMC)

Copper Inserts

Brass has better thermal conductivity product gets hork quickly increase productivity.



Packing



Recommand Product

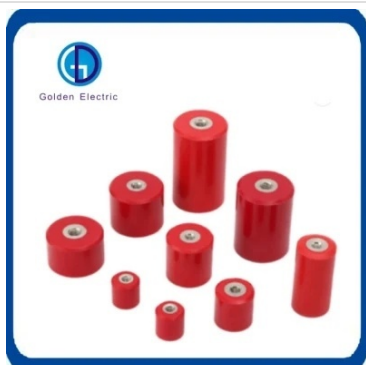

Company Profile

- Golden Electric Co.,Ltd ,was founded in 2007, we are professional for make AC and DC electric items such as cable gland,MC4 Connector, isolator switch , fuse , breaker , distribution box , PV combiner box ,surge protector, Indicator lamp,Solar Charge Controller,Industrial plug and socket,Busbar Insulator,Meter Socket,Wind Turbine, Terminal Block,Solar product and so on.

- Golden has been granted ISO9001 management system certifications. The comprehensive product line has more than 1000 models which have been approved by TUV,CE,CQC,SGS,ROHS,SASO. The productsells well to UK, Spain, Portugal, Singapore, Turkey, Russia, Korea, South Africa... more than 60 countries and regions.

- Golden is always striving hard to provide the best services and competitive price to all customers.

FAQ

1)Q:How can i trust your company?

A:Golden electric is The top 10 manufacture in China- more than 350 Agents in local market and more than 100

foreign clients make OEM,ODM order from us,Golden electric is a big company, we have cooperation with LS, EKF the world-class companies. Our company over 100 employees, products pass CE,IEC,TUV,SAA, RCM, ROHS certificates.

2) Q:Your products?

A: Golden electric is factory for Automatic transfer switch, Surge protector device, distribution box Enclosure, inverter, DC fuse etc. Providing customers very competitive sources, and can be your sourcing agent in China. Goods are following international standards, IE, CE, ISO9001 ,SGS etc.

3) Q: Do you have forwarder?

A: Yes, we have good forwarder cooperated over 10 years, they help us import and export . For small package orders, suggest to use by Express.

4) Q: Your address ?

A: Locates in Guangzhou province, China,welcome to visit us

5) Q:What's the Insulator guarantee?

A: 2 years warranty. If customer's problem, then customer burden. If our problem, then we send new goods to customer to replace asap.

6) Q:What's about MOQ? Delivery time ?

A: 1pcs for Insulator.

7) Q: What's the payment term?

A: Normally 100% T/T in advanced payment. If big order then about 50% advanced payment, balance before shipment.PAYPAL,WESTERN UNION,CASH for small order .

8) Q:What's your contact information ?

Send us your *inquiry* !we will reply you in 24 hours !

If you need information about this product. Please *Click here* to contact me and we will provide you with more information about the products.



Guangzhou Golden Electric Co., Ltd.



008618998498109



eva@china-golden.com.cn



chinagoldene.com

Building 4, Self-edited Building, No. 728, Kaichuang Avenue, Yunpu Industrial Zone, Huangpu District,
Guangzhou city,Guangdong province,China