



## SM Series M6 M8 M10 Screw Bus Bar Insulator for Switchgear Best Epoxy Resin Insulator

Our Product Introduction

### Basic Information

- Place of Origin: China
- Brand Name: Golden Electric /OEM
- Certification: ISO 9001, ISO 9000, ISO 14001, ISO 14000, ISO 20000, OHSAS/ OHSMS 18001, IATF16949
- Minimum Order Quantity: 1
- Packaging Details: Carton/Pallet
- Delivery Time: Peak Season Lead Time: more than 12 months  
Off Season Lead Time: within 15 workdays
- Payment Terms: LC, T/T, PayPal, Western Union
- Supply Ability: 5000/Month



### Product Specification

- Color: Red Or Black
- Brand: Golden Electric /OEM
- Insert: Copper ,Steel With Zn Coating
- Working Voltage: 600V
- Pulse Voltage: 5000V
- Insulation Resistance: 500mΩ
- Screw Depth(mm): 6-10mm
- Operating Temperature: -40~+140
- Product Name: Low Voltage Busbar Insulator
- Warranty: 2 Years
- Model No.: Sm Series
- Transport Package: Standard Export Carton
- Specification: SM25 SM30 SM35 SM40 SM51 SM76
- Trademark: Golden Or Natural, Or Customer Brand
- Origin: China



### More Images



for more products please visit us on [chinagoldene.com](http://chinagoldene.com)

## Product Description

### Product Description

Bsubar insulators are made from flame retardant fiberglass reinforced polyester and are stronger and hold closer tolerances than the traditional porcelain insulators. Our range of stand-off insulators isolates electrical conductors from mechanical mounting, preventing short circuits, Combine high mechanical strength with high arc resistance.

Insulator is the special part to fix,install and insulat on communication, electric power, lightning protection, machinery, medical, wind energy, frequency conversion equipment,new energy vehicles (integrated chassis cabinets, locker, etc.) to provide meet the fixed support, installation and insulation isolation effect of special parts, it is also known as insulators, insulation column .Its appearance is usually the cylinder,hexagonal,round.There is the insert on the two surface of insulator.

### Product Parameters

Item	Tensile strength (LBS)	Torque Strength (FT LBS)	Voltage withstand (KV)	Screw (mm)	Screw Depth
SM-20	300	4	5	M5	7mm
SM-25S	400	5	6	M6	8mm
SM-25	500	6	6	M6	9mm
SM-30	550	8	8	M6	11mm
SM-35	600	10	10	M8	11mm
SM-40	650	12	12	M8	11mm
SM-45	1000	20	14	M8	11mm
SM-51	1000	20	15	M8	14mm
SM-60	1200	40	25	M10	20mm
SM-76	1500	40	25	M10	20mm

SM 绝缘子系列 Insulator Series



型号及含义 Type and Meaning



产品性能 Product performance

工作温度：-40℃~+140℃；  
螺母：黄铜、铁；  
材料：不饱和聚酯树玻璃纤维增强压塑料(BMC)(SMC)；  
颜色、嵌件、材料性能可依客户需求定制。  
安装螺丝(附件选配)  
Operating temperature: -40~140;  
Nuts: brass, iron;  
Material: unsaturated polyester tree glass fiber reinforced compressive plastics (BMC) (SMC);  
The color, insert and material properties can be customized according to customer requirements.  
Installation screw (accessory selection)

SM-20绝缘端子  
Insulated terminal

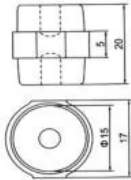

镶（嵌）件 Mosaic	
螺母规格Nut specification	M5/M6
螺孔深度Screw hole depth	7mm
螺母材料Nut material	铜copper
强度 Strength	
轴向抗拉Axial tension	500N
抗弯Bending resistance	1000N
拧紧力矩Tightening torque	8N/m

绝缘性能 Insulation property	
绝缘电阻 insulation resistance	300mΩ
电性能 Electrical properties	
工作电压working voltage	600V
脉冲电压Pulse voltage	3000V
漏电流在2000V的工作电压下 Leakage current at 2000 VWorking Voltage	<1mA
耐压 Withstand voltage	5kv

SM-25绝缘端子  
Insulated terminal

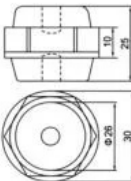

镶（嵌）件 Mosaic	
螺母规格Nut specification	M5/M6
螺孔深度Screw hole depth	9mm
螺母材料Nut material	铜copper
强度 Strength	
轴向抗拉Axial tension	2000N
抗弯Bending resistance	3000N
拧紧力矩Tightening torque	10N/m

绝缘性能 Insulation property	
绝缘电阻 insulation resistance	500mΩ
电性能 Electrical properties	
工作电压working voltage	600V
脉冲电压Pulse voltage	3000V
漏电流在2000V的工作电压下 Leakage current at 2000 VWorking Voltage	<1mA
耐压 Withstand voltage	6kv

SM-25S绝缘端子  
Insulated terminal

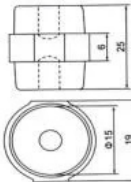

镶（嵌）件 Mosaic	
螺母规格Nut specification	M6
螺孔深度Screw hole depth	9mm
螺母材料Nut material	铜copper
强度 Strength	
轴向抗拉Axial tension	800N
抗弯Bending resistance	2000N
拧紧力矩Tightening torque	8N/m

绝缘性能 Insulation property	
绝缘电阻 insulation resistance	300mΩ
电性能 Electrical properties	
工作电压working voltage	600V
脉冲电压Pulse voltage	3000V
漏电流在2000V的工作电压下 Leakage current at 2000 VWorking Voltage	<1mA
耐压 Withstand voltage	5kv

SM 绝缘子系列 Insulator Series



型号及含义 Type and Meaning



产品性能 Product performance

工作温度: -40℃~+140℃;  
螺母: 黄铜、铁;  
材料: 不饱和聚酯树脂玻璃纤维增强压塑料(BMC)(SMC);  
颜色、嵌件、材料性能可依客户需求定制。  
安装螺丝(附件选配)  
Operating temperature: -40~140;  
Nuts: brass, iron;  
Material: unsaturated polyester tree glass fiber reinforced compressive plastics (BMC) (SMC);  
The color, insert and material properties can be customized according to customer requirements.  
Installation screw (accessory selection)

SM-30绝缘端子  
Insulated terminal

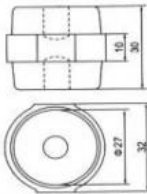

镶 ( 嵌 ) 件 Mosaic		绝缘性能 Insulation property	
螺母规格Nut specification	M6/M8	绝缘电阻 insulation resistance	500mΩ
螺孔深度Screw hole depth	9mm/10mm	电性能 Electrical properties	
螺母材料Nut material	铜copper	工作电压working voltage	600V
强度 Strength		脉冲电压Pulse voltage	3000V
轴向抗拉Axial tension	2000N	漏电流在2000V的工作电压下 Leakage current at 2000 VWorking Voltage	<1mA
抗弯Bending resistance	4000N		
拧紧力矩Tightening torque	10N/m	耐压 Withstand voltage	8kv

SM-35绝缘端子  
Insulated terminal

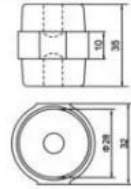

镶 ( 嵌 ) 件 Mosaic		绝缘性能 Insulation property	
螺母规格Nut specification	M6/M8	绝缘电阻 insulation resistance	>500mΩ
螺孔深度Screw hole depth	10mm/10mm	电性能 Electrical properties	
螺母材料Nut material	铜copper	工作电压working voltage	600V
强度 Strength		脉冲电压Pulse voltage	5000V
轴向抗拉Axial tension	300N	漏电流在2000V的工作电压下 Leakage current at 2000 VWorking Voltage	<1mA
抗弯Bending resistance	4000N		
拧紧力矩Tightening torque	12N/m	耐压 Withstand voltage	10kv

SM-40绝缘端子  
Insulated terminal

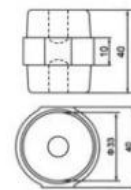

镶 ( 嵌 ) 件 Mosaic		绝缘性能 Insulation property	
螺母规格Nut specification	M8/M10	绝缘电阻 insulation resistance	>1500mΩ
螺孔深度Screw hole depth	10.5mm/13.5mm	电性能 Electrical properties	
螺母材料Nut material	铜copper	工作电压working voltage	600V
强度 Strength		脉冲电压Pulse voltage	5000V
轴向抗拉Axial tension	3000N	漏电流在2000V的工作电压下 Leakage current at 2000 VWorking Voltage	<1mA
抗弯Bending resistance	5000N		
拧紧力矩Tightening torque	15N/m	耐压 Withstand voltage	10kv

SM 绝缘子系列 Insulator Series

●型号及含义 Type and Meaning



●产品性能 Product performance

工作温度：-40℃~+140℃；  
螺母：黄铜、铁；  
材料：不饱和聚酯树脂玻璃纤维增强塑料(BMC)(SMC)；  
颜色、嵌件、材料性能可依客户需求定制。  
安装螺丝(附件选配)  
Operating temperature: - 40 ~ 140;  
Nuts: brass, iron;  
Material: unsaturated polyester tree glass fiber reinforced compressive plastics (BMC) (SMC);  
The color, insert and material properties can be customized according to customer requirements.  
Installation screw (accessory selection)



SM-45绝缘端子  
Insulated terminal

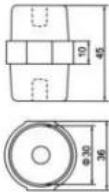

锁 ( 嵌 ) 件 Mosaic		绝缘性能 Insulation property	
螺母规格Nut specification	8M/M10	绝缘电阻 insulation resistance	>1000mΩ
螺孔深度Screw hole depth	10.5/13.5mm	电性能 Electrical properties	
螺母材料Nut material	铜copper	工作电压working voltage	600V
强度 Strength		脉冲电压Pulse voltage	5000V
轴向抗拉Axial tension	4000N	漏电流在2000V的工作电压下 Leakage current at 2000 VWorking Voltage	<1mA
抗弯Bending resistance	5500N		
拧紧力矩Tightening torque	15N/m	耐压 Withstand voltage	10kv

SM-51绝缘端子  
Insulated terminal

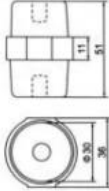

锁 ( 嵌 ) 件 Mosaic		绝缘性能 Insulation property	
螺母规格Nut specification	M8/M10	绝缘电阻 insulation resistance	>1000mΩ
螺孔深度Screw hole depth	10.5/13.5mm	电性能 Electrical properties	
螺母材料Nut material	铜copper	工作电压working voltage	600V
强度 Strength		脉冲电压Pulse voltage	5000V
轴向抗拉Axial tension	300N	漏电流在2000V的工作电压下 Leakage current at 2000 VWorking Voltage	<1mA
抗弯Bending resistance	5000N		
拧紧力矩Tightening torque	15N/m	耐压 Withstand voltage	12kv

SM-60绝缘端子  
Insulated terminal

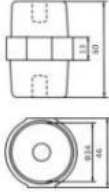

锁 ( 嵌 ) 件 Mosaic		绝缘性能 Insulation property	
螺母规格Nut specification	M10	绝缘电阻 insulation resistance	>1000mΩ
螺孔深度Screw hole depth	13.5mm	电性能 Electrical properties	
螺母材料Nut material	铜copper	工作电压working voltage	600V
强度 Strength		脉冲电压Pulse voltage	5000V
轴向抗拉Axial tension	300N	漏电流在2000V的工作电压下 Leakage current at 2000 VWorking Voltage	<1mA
抗弯Bending resistance	5000N		
拧紧力矩Tightening torque	15N/m	耐压 Withstand voltage	20kv

SM 绝缘子系列 Insulator Series



•型号及含义 Type and Meaning



•产品性能 Product performance

工作温度：-40℃~+140℃；  
螺母：黄铜、铁；  
材料：不饱和聚酯树脂玻璃纤维增强塑料(BMC)(SMC)；  
颜色、嵌件、材料性能可依客户需求定制。  
安装螺丝(附件选配)  
Operating temperature: -40~140;  
Nuts: brass, iron;  
Material: unsaturated polyester tree glass fiber reinforced compressive plastics (BMC) (SMC);  
The color, insert and material properties can be customized according to customer requirements.  
Installation screw (accessory selection)

SM-76绝缘端子  
Insulated terminal

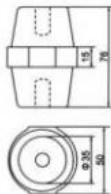

镶（嵌）件 Mosaic	
螺母规格Nut specification	M10
螺孔深度Screw hole depth	13.5mm
螺母材料Nut material	铜copper
强度 Strength	
轴向抗拉Axial tension	4000N
抗弯Bending resistance	5000N
拧紧力矩Tightening torque	20N/m

绝缘性能 Insulation property	
绝缘电阻 insulation resistance	>1500mΩ
电性能 Electrical properties	
工作电压working voltage	1500V
脉冲电压Pulse voltage	10000V
漏电流在2000V的工作电压下 Leakage current at 2000 VWorking Voltage	<1mA
耐压 Withstand voltage	25kv

SM-100绝缘端子  
Insulated terminal

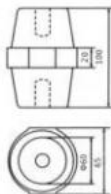

镶（嵌）件 Mosaic	
螺母规格Nut specification	M10
螺孔深度Screw hole depth	13.5mm
螺母材料Nut material	铜copper
强度 Strength	
轴向抗拉Axial tension	4000N
抗弯Bending resistance	5000N
拧紧力矩Tightening torque	20N/m

绝缘性能 Insulation property	
绝缘电阻 insulation resistance	>1500mΩ
电性能 Electrical properties	
工作电压working voltage	1500V
脉冲电压Pulse voltage	10000V
漏电流在2000V的工作电压下 Leakage current at 2000 VWorking Voltage	<1mA
耐压 Withstand voltage	25kv

SM-7105绝缘端子  
Insulated terminal

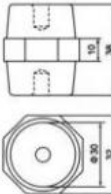

镶（嵌）件 Mosaic	
螺母规格Nut specification	M6/M8
螺孔深度Screw hole depth	10/13.5mm
螺母材料Nut material	铜copper
强度 Strength	
轴向抗拉Axial tension	4000N
抗弯Bending resistance	5000N
拧紧力矩Tightening torque	12N/m

绝缘性能 Insulation property	
绝缘电阻 insulation resistance	>1500mΩ
电性能 Electrical properties	
工作电压working voltage	1500V
脉冲电压Pulse voltage	10000V
漏电流在2000V的工作电压下 Leakage current at 2000 VWorking Voltage	<1mA
耐压 Withstand voltage	25kv

Product Features



Material

Made of high quality molded unsaturated polyester glass fiber resin force plastic(BMC)

Copper Inserts

Brass has better thermal conductivity product gets hork quickly increase productivity.



Packing



#### Recommand Product



#### Company Profile

- Golden Electric Co.,Ltd ,was founded in 2007, we are professional for make AC and DC electric items such as cable gland,MC4 Connector, isolator switch , fuse , breaker , distribution box , PV combiner box ,surge protector, Indicator lamp,Solar Charge Controller,Industrial plug and socket,Busbar Insulator,Meter Socket,Wind Turbine, Terminal Block,Solar product and so on.
- Golden has been granted ISO9001 management system certifications. The comprehensive product line has more than 1000 models which have been approved by TUV,CE,CQC,SGS,ROHS,SASO. The productsells well to UK, Spain, Portugal, Singapore, Turkey, Russia, Korea, South Africa... more than 60 countries and regions.
- Golden is always striving hard to provide the best services and competitive price to all customers.

#### FAQ

1)Q:How can i trust your company?

A:Golden electric is The top 10 manufacture in China- more than 350 Agents in local market and more than 100

foreign clients make OEM,ODM order from us,Golden electric is a big company, we have cooperation with LS, EKF the world-class companies. Our company over 100 employees, products pass CE,IEC,TUV,SAA, RCM, ROHS certificates.

**2) Q:Your products?**

A: Golden electric is factory for Automatic transfer switch, Surge protector device, distribution box Enclosure, inverter, DC fuse etc. Providing customers very competitive sources, and can be your sourcing agent in China. Goods are following international standards, IE, CE, ISO9001 ,SGS etc.

**3) Q: Do you have forwarder?**

A: Yes, we have good forwarder cooperated over 10 years, they help us import and export . For small package orders, suggest to use by Express.

**4) Q: Your address ?**

A: Locates in Guangzhou province, China,welcome to visit us

**5) Q:What's the Insulator guarantee?**

A: 2 years warranty. If customer's problem, then customer burden. If our problem, then we send new goods to customer to replace asap.

**6) Q:What's about MOQ? Delivery time ?**

A: 1pcs for Insulator.

**7) Q: What's the payment term?**

A: Normally 100% T/T in advanced payment. If big order then about 50% advanced payment, balance before shipment.PAYPAL,WESTERN UNION,CASH for small order .

**8) Q:What's your contact information ?**

**Send us your *inquiry* !we will reply you in 24 hours !**

**If you need information about this product. Please [Click here](#) to contact me and we will provide you with more information about the products.**



**Guangzhou Golden Electric Co., Ltd.**



008618998498109



eva@china-golden.com.cn



chinagoldene.com

Building 4, Self-edited Building, No. 728, Kaichuang Avenue, Yunpu Industrial Zone, Huangpu District,  
Guangzhou city,Guangdong province,China