



PVC Shell Cal Dtl-2 Bimetallic Copper Aluminum 240mm Cable Lugs for Injection Molding

Our Product Introduction

Basic Information

- Place of Origin: China
- Brand Name: Golden Electric /OEM
- Certification: ISO 9001, ISO 9000, ISO 14001, ISO 14000, ISO 20000, OHSAS/ OHSMS 18001, IATF16949
- Minimum Order Quantity: 1
- Packaging Details: Carton/Pallet
- Delivery Time: Peak Season Lead Time: more than 12 months Off Season Lead Time: within 15 workdays
- Payment Terms: LC, T/T, PayPal, Western Union
- Supply Ability: 5000/Month



Product Specification

- Model NO.: CAL
- Shape: Tubular
- Interface Type: AC/DC
- Brand: Golden Electric/OEM
- Rated Voltage: 415V
- Entry: Chamfered Entry
- Busbar: -55c~150c
- Size: 16-800mm²
- Coating: Tin
- OEM: Accept
- Sample: Accept
- Wire Range: 22~16/16~14/14~12/12~10 A.W.G
- Color: Natural
- Product Key Words: Insulated Terminal Blocks
- Shell Material: PVC



More Images

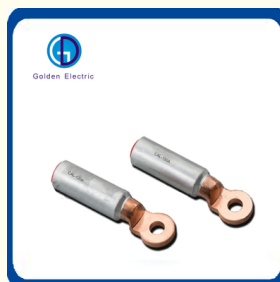
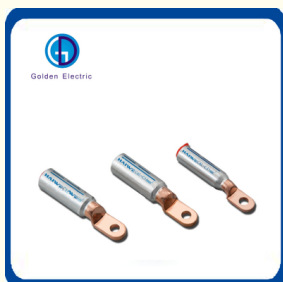

for more products please visit us on chinagoldene.com

Product Description

Product Description



型号含义 Type Meaning



CAL A Copper Aluminum Bimetal Cable Lug

Material:

E-Cu; Al-99.6%

Technical Requirements

1. Due to the coupling effect when Aluminum Comes in contact with copper, corrosion will happen in the short time.

The best solution is to use aluminum-copper bimetal connectors. It is according with IEC 61238-1.

2. The transition section between aluminum and copper is produced by friction welding, bending 180°, no breaking weld.

3. The marking should be clearly, well-proportioned with the depth of 3mm;

4. Closed angle and edge curl are not allowed at the mouth of the pipe.



Product Parameters

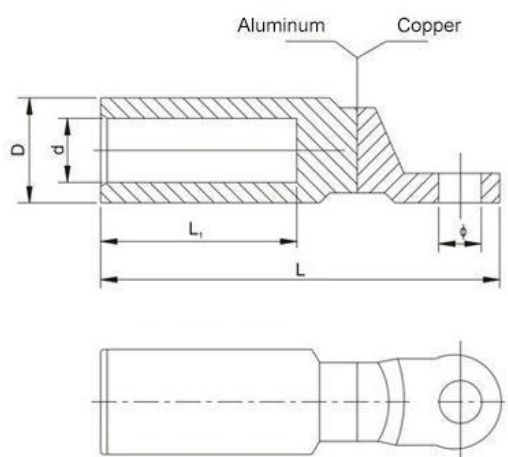

Type No	Main Dimensions(mm)				
	Φ	D	d	L	L1
CAL-16A	11	16	5.5	83	42
CAL-25A	11	16	6.5	83	42
CAL-35A	11	16	8	83	42
CAL-50A	13	20	9	90	43
CAL-70A	13	20	11	90	43
CAL-95A	13	20	12.5	90	43

CAL-120A	13	25	13.5	115	60
CAL-150A	13	25	15.5	115	60
CAL-185A	13	32	17.5	125	60
CAL-240A	13	32	19.5	125	60
CAL-300A	13	34	22.5	135	62

Packaging & Shipping

Terminal Value Of Packaging



Value Pack: N-175(plastic box)
175 PCS 16 TYPE Assortment

编 号 ITEM.NO.	数量 QTY	编 号 ITEM.NO.	数量 QTY	编 号 ITEM.NO.	数量 QTY
RV1.25-3	15	RV5.5-5	5	BV2	10
RV51.25-4	10	RV5.5-6	5	BV5.5	5
RV1.25-5	10	SV1.25-3	10	MDD1.25-250	10
RV2-3	15	SV51.25-4	10	MDD2-250	10
RV52-4	10	SVL2-4	10	FDD1.25-250	10
RVL2-5	10	BV1.25	10	FDD2-250	10



Value Pack: N-175(plastic box)
175 PCS 18 TYPE Assortment

编 号 ITEM.NO.	数量 QTY	编 号 ITEM.NO.	数量 QTY	编 号 ITEM.NO.	数量 QTY
RV1.25-3	25	RV5.5-5	5	Bx2	10
RV51.25-4	25	RV5.5-6	5	BV5.5	5
RV1.25-5	25	SV1.25-3	20	MDD1.25-250	20
RV2-3	15	SV51.25-4	20	MDD2-250	20
RV52-4	20	SVL2-4	20	FDD1.25-250	20
RVL2-5	10	BV1.25	10	FDD2-250	20

Packaging Details:

Customized Packing: Header card packing, Blister with card packing, Double blister packing, Canister packing, other packing can be supplied according customers request.

Shipping:

1. By Air or by Sea for batch goods,Airport/ Port receiving;
2. Customers specifying freight forwarders or negotiable shipping methods!

Delivery Detail:

Shipped in 7 days after payment

Company Profile

- Golden Electric Co.,Ltd ,was foundad in 2017, we are professional for make **AC and DC electric items** such as cable gland,cable tie ,isolator switch , fuse , breaker , distribution box , PV combiner box ,surge protector, Industrial plug and socket,Solar product and so on.

- Golden has been granted ISO9001 management system certifications. The comprehensive product line has more than 1000 models which have been approved by TUV,CE,CQC,SGS,ROHS,SASO. The productsells well to UK, Spain, Portugal, Singapore, Turkey, Russia, Korea, South Africa... more than 60 countries and regions.

- Golden is always striving hard to provide the best services and competitive price to all customers.

Recommend Products



Closed end Terminal



Nylon Connectors



Tube Type Terminal



Plug-in Terminal



Copper Bare Terminal



Insulated Copper Terminals

Our Advantages

1. Best ensure 100% customer satisfaction.
2. Our products have one year guarantee.
3. Sample in design and easy to operate and maintain.
4. All electrical parts of products are made up for qualified materials.
5. No MOQ limited for the trial order.
6. We adopt good credit quality electrical appliances.
7. Best customer care and efficient after-sale services.
8. Don't hesitate to inquire us, we will reply you within 12 hours.

Production and transport



FAQ

Q1: Could I Put My Own Logo On It?

A1: Sure, of course, we are a professional manufacturer and have over 10 years OEM experience, customer's logo can be made by laser, engraved, embossed, transfer printing etc.

Q2: What's the delivery time?

A2: Normally, 3-15 days after order and payment confirmation. Actually, it will depend on your order quantity.

Q3: What's your terms of payment?

A3: T/T 30% as deposit, and 70% before delivery. We'll show you the photos of the products and packages before you pay the balance.

Q4: How do you make our business long-term and good relationship?

A4: a. We keep good quality and competitive price to ensure our customers benefit; b. We respect every customer as our friend and we sincerely do business and make friends with them, no matter where they come from.

Q5: If we bought your products, but found quality problem, how to solve?

A5: After confirmed, if the quality problem is caused by us not for outer sector, we will compensate each piece to customer.

How to contact us

Send your Inquiry Details in the Below, please Click "[send](#)" Now!
Good price and sample are waiting for you.



Guangzhou Golden Electric Co., Ltd.



008618998498109



eva@china-golden.com.cn



chinagoldene.com

Building 4, Self-edited Building, No. 728, Kaichuang Avenue, Yunpu Industrial Zone, Huangpu District,
Guangzhou city,Guangdong province,China