



High Conductivity Galvanized Ground Rods Earth Rod for Earth System Zinc Thickness 70μm

Our Product Introduction

Basic Information

- Place of Origin: China
- Brand Name: Golden Electric /OEM
- Certification: ISO 9001, ISO 9000, ISO 14001, ISO 14000, ISO 20000, OHSAS/ OHSMS 18001, IATF16949
- Model Number: Ccsep22
- Minimum Order Quantity: 1
- Packaging Details: Carton/Pallet
- Delivery Time: Peak Season Lead Time: more than 12 months Off Season Lead Time: within 15 workdays
- Payment Terms: LC, T/T, PayPal, Western Union
- Supply Ability: 5000/Month



Product Specification

- Tensile Life: ≥ 30 years
- Tensile Strength: ≥ 370 N/mm²
- Application: Power System
- Zinc Thickness: 70μm
- Manufacturer: Yes
- Transport Package: Ocean Freight Woven Belt+Iron Pallet+Container
- Specification: Different Sizes And Specifications
- Trademark: Golden Electric Or Customize
- Origin: China
- HS Code: 7308900000
- Supply Ability: 5000/Month
- Type: DIP Galvanized Ground Rod
- Standard: GB
- Certification: ISO

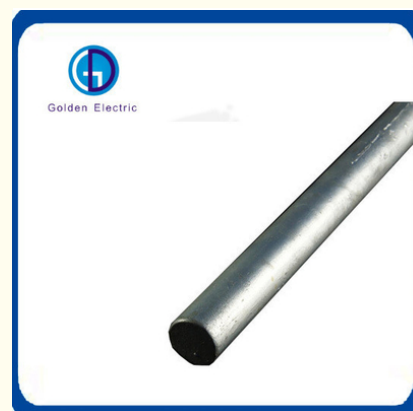

More Images



for more products please visit us on chinagoldene.com

Product Description

Company

Profile

GoldenElectricCo., Ltd.

is professional make of Electrical products .Such as distribution box, waterproof plug, socket, wall switch, waterproof plastic ,Aluminum box ,Changeover Switch and disconnecting switch,MC4 Connector.isolator switch.fusebreaker.distribution box,PV combiner box .surge protector, Indicatorlamp,Solar Charge Controller,Industrialplugandsocket,BusbarInsulator,Meter Socket,Wind Turbine, Terminal Block,Solar product and so on. all products comply with IEC, A S/NZS standard. passed CE, IP66, ROHS certificates.at present we have exported to many countries and have serve these customers with professional electrical solution.

Product Description

The copper-clad steel grounding rod made of low-carbon steel core combines 99.9% pure electrolytic copper, which has good conductivity, corrosion resistance and tensile strength, with a service life of more than 30 years. There are three different types of copper clad steel grounding rod, among which the threaded type can effectively slow down the oxidation rate of the grounding rod in the underground. It can be widely used in communication industry, power system, building system, military facilities, railway system, etc., especially for the ground engineering with poor environment and high corrosion resistance requirements. It has a broad market prospect.



Advantages of copper clad steel material:The copper-clad steel grounding rod has the characteristics of both high conductivity motor and steel. The copper-clad steel grounding rod is used in general environment and special environment of wet, salt alkali,acid mud, copper-clad steel grounding rod soil and chemical erosion medium. Generally, anti-corrosion treatment is not required.After copper corrosion, the surface is close to the steel, so that it can better integrate into the earth.

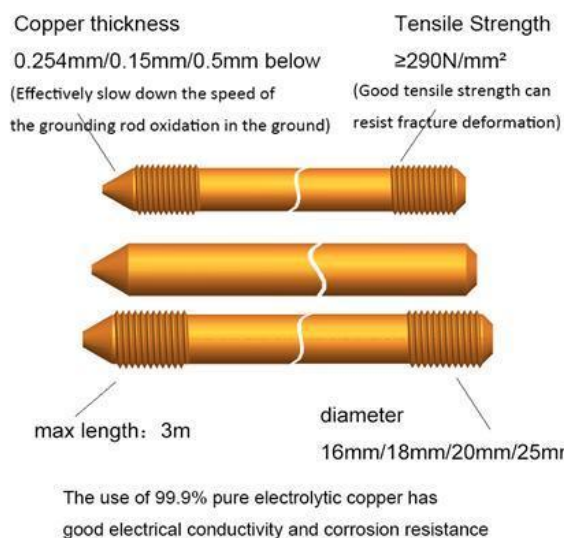

There are three types of products: one point one flat, two thread, thread with a point, in order to adapt to a variety of occasions

One point one flat earth rod:

The one point and one flat earth bar produced is the one with the highest overall strength among all the earth bar styles. It can be driven into the ground directly by heavy hammer without other accessories, which is convenient and quick to use and has low installation cost.

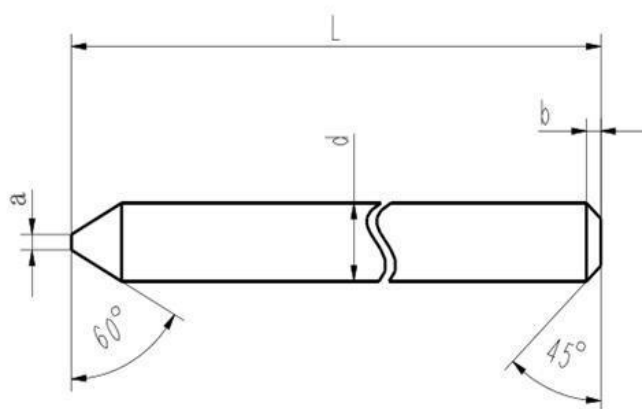

Ground rod dimensions and tolerances

diameter Φ(mm)	diameter and tolerance d(mm)	length L(mm)	end structure a(mm)	end structure b(mm)
14.2	14.2±0.05	1200	3±1	2.5±0.5
		1500		
		1800		
		3000		
16	16±0.05	1200	3±1	3.0±0.5
		1500		
		1800		
		3000		
17.2	17.2±0.05	1200	4±1	3.5±1
		1500		
		1800		
		3000		
18	18±0.05	1200	4±1	3.5±1
		1500		
		1800		
		3000		
20	20±0.05	1200	5±1	4.0±1
		1500		
		1800		
		3000		

25	25±0.05	1200	5±1	5.0±1
		1500		
		1800		
		3000		

Two thread earth rod:

The dual-thread earth rod is equipped with coaxial connector, drive head and drill bit. The length of the cast copper ground rod can be arbitrarily increased. The driving head (connecting bolt) is used to connect the item end, which is used for striking when the rod is deep. The end is connected with a special bit (connecting bolt) to make it easier to hit the bar deep.

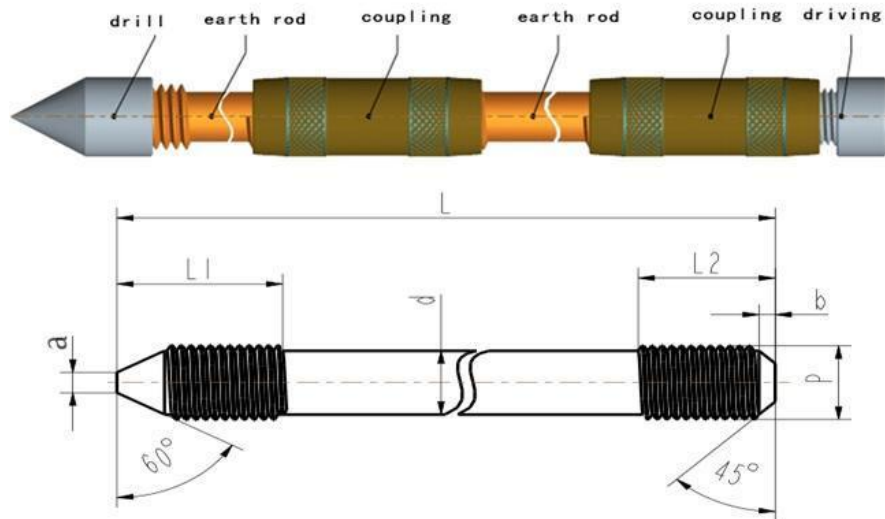

Ground rod dimensions and tolerances

diameter Φ (mm)	diameter and tolerance d(mm)	length L(m)	screw thread L1(mm)	screw thread L2(mm)	screw thread P(mm)	end structure a(mm)	end structure b(mm)
14.2	14.2±0.05	1200					
		1500	35	37	M16	6±1	2.5±0.5
		1800	(+3,-2)	(+3,-2)	5/8		
		3000					
16	16±0.05	1200					
		1500	35	37	M18	6±1	3.0±0.5
		1800	(+3,-2)	(+3,-2)			
		3000					
17.2	17.2±0.05	1200					
		1500	35	37	3/4	7±1	3.5±1
		1800	(+3,-2)	(+3,-2)			
		3000					
18	18±0.05	1200					
		1500	35	37	M20	7±1	4.0±1
		1800	(+3,-2)	(+3,-2)			
		3000					
20	20±0.05	1200					
		1500	35	37	M22	8±1	4.0±1
		1800	(+3,-2)	(+3,-2)			
		3000					
25	25±0.05	1200					
		1500	35	37	M27	8±1	5.0±1
		1800	(+3,-2)	(+3,-2)			
		3000					

Thread with a point earth rod:

Thread with a point earth rod can be connected to two or more ground rods by means of coaxial connector. The ground The depth can be flexibly configured to meet The company requirements of The same project.

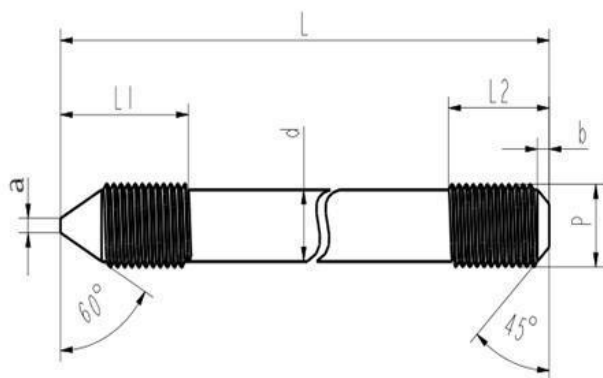

Ground rod dimensions and tolerances

diameter Φ (mm)	diameter and tolerance d(mm)	length L(m)	screw thread L1(mm)	screw thread L2(mm)	screw thread P(mm)	end structure a(mm)	end structure b(mm)
14.2	14.2±0.05	1200					
		1500	35	37	M16	3±1	2.5±0.5
		1800	(+3,-2)	(+3,-2)	5/8		
		3000					
16	16±0.05	1200					
		1500	35	37	M18	3±1	3.0±0.5
		1800	(+3,-2)	(+3,-2)			
		3000					
17.2	17.2±0.05	1200					
		1500	35	37	3/4	4±1	3.5±1
		1800	(+3,-2)	(+3,-2)			
		3000					
18	18±0.05	1200					
		1500	35	37	M20	4±1	4.0±1
		1800	(+3,-2)	(+3,-2)			
		3000					
20	20±0.05	1200					
		1500	35	37	M22	5±1	4.0±1
		1800	(+3,-2)	(+3,-2)			
		3000					
25	25±0.05	1200					
		1500	35	37	M27	5±1	5.0±1
		1800	(+3,-2)	(+3,-2)			
		3000					

Use of the
products

1.Composition and structure of grounding rod

The grounding rod is composed of insulated operating rod (The operating rod is made of high-quality glass fiber reinforced epoxy resin rod. The connecting wire clip is equipped with flat end spiral hook, double spring hook, throat hook, etc.)Generally, there are 3 or 4 for each group of indoor high and low voltage, and generally 3 for outdoor high voltage. The length of the operating rod selected for each voltage level is also different according to the national standards and regulations, and the national standards should also be considered when selecting.

2. How to use the grounding rod

When using the grounding rod, pay attention to connecting the installed ion grounding rod electrode with bare copper cable to form a main ring. The connection point is exothermic welding, and the drilling hole should not be greater than 155mm, so as to avoid insufficient filling of filler; When covering the protective cap, it shall be noted that the air vent on the rod shall not be blocked by soil or filler, and the air vent on the cap shall be above the backfill soil and shall not be blocked. The outgoing line should be 95mm² multi strand copper wire, and the outgoing line and grounding electrode should be connected by exothermic welding; When one set of grounding electrodes fails to meet the requirements of ground resistance, two or more sets of grounding electrodes can be used in parallel, and the interval between rods should not be less than 5m.

When using, first drill out at the selected construction site ϕ 155mmX315mm holes vertical to the ground;

Secondly, put 50kg fresh water into a container with a volume greater than 150L, add initiator, stir until all are dissolved, add synergistic ion filler, stir until paste, and prepare filler; Thirdly, remove the sealing tape at both ends of the grounding electrode, fill the filler prepared in 1:4 into the hole bottom and implant the grounding electrode into the hole, and the top of the grounding electrode is parallel to the ground plane; For the grounding outgoing line, fill the rest of the filler around the grounding electrode to 100mm above the top of the grounding electrode, implant the grounding electrode, cover the protective cap, measure the grounding resistance, and fill the area around the protective cap with soil, with the top of the cap 100mm above the ground. The use of electrolytic ion grounding rod should pay attention to strategy so as to do a good job without time and effort.

Products Category



Solar PV Junction Box



Weatherproof Wall Socket and Switch



Electrical Junction Box



Solar PV DC Fuse Components

Packing & Delivery

Packaging Details: woven belt+Iron pallet+container

Lead time:

Quantity(pieces) 1 - 1000 > 1000

Lead time (days) 15 To be negotiated

FAQ

Q1: Are you a factory or trading company

A1: We are a factory, we can guarantee our price is first-hand, very cheap and competitive.

Q2: How does your factory do regarding quality control?

A2: All the products will be 100% checked before the shipment

Q3: When can I get the price?

A3: Usually we quote within 24 hours after we get your inquiry.

Q4: How could I get a sample?

A4: if you can not buy our product in your local area, we will ship a sample to you. You will be charged a sample price plus all related shipping costs. Express delivery charge depends on the quantity of the samples.

Q5: What is the price of shipping?

A5: Depending upon the port of delivery, prices vary.

Any more query please contact with us, thank you!



Guangzhou Golden Electric Co., Ltd.



008618998498109



eva@china-golden.com.cn



chinagoldene.com

Building 4, Self-edited Building, No. 728, Kaichuang Avenue, Yunpu Industrial Zone, Huangpu District,
Guangzhou city, Guangdong province, China