



## Different Sizes and Specifications Stainless Steel Rods for Construction Projects

Our Product Introduction

### Basic Information

- Place of Origin: China
- Brand Name: Golden Electric /OEM
- Certification: ISO 9001, ISO 9000, ISO 14001, ISO 14000, ISO 20000, OHSAS/ OHSMS 18001, IATF16949
- Model Number: Blj-Rod
- Minimum Order Quantity: 1
- Packaging Details: Carton/Pallet
- Delivery Time: Peak Season Lead Time: more than 12 months Off Season Lead Time: within 15 workdays
- Payment Terms: LC, T/T, PayPal, Western Union
- Supply Ability: 5000/Month



### Product Specification

- Quality: Reliable
- Material: Copper, Brass, Stainless Steel, Galvanized
- Certificate: ISO9001
- Transport Package: Ocean Freight Woven Belt+Iron Pallet+Container
- Specification: Different Sizes And Specifications
- Trademark: Golden Electric Or Customize
- Origin: China
- HS Code: 7308900000
- Supply Ability: 5000/Month
- Type: Stainless Steel Bars
- Standard: GB
- Certification: ISO
- Shape: Round
- Technique: Welded



### More Images

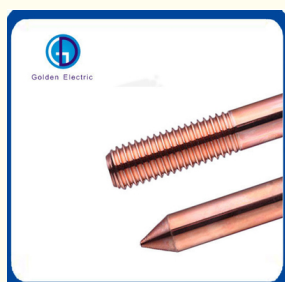

for more products please visit us on [chinagoldene.com](http://chinagoldene.com)

## Product Description

### Company

#### Profile

GoldenElectricCo., Ltd.

is professional make of Electrical products .Such as distribution box, waterproof plug, socket, wall switch, waterproof plastic ,Aluminum box ,Changeover Switch and disconnecting switch,MC4 Connector.isolator switch.fusebreaker.distribution box,PV combiner box .surge protector, Indicatorlamp,Solar Charge Controller,Industrialplugandsocket,BusbarInsulator,Meter Socket,Wind Turbine, Terminal Block,Solar product and so on. all products comply with IEC, A S/NZS standard. passed CE, IP66, ROHS certificates.at present we have exported to many countries and have serve these customers with professional electrical solution.

### Product Description

The THREADED grounding rod made of low-carbon steel core combines 99.9% pure electrolytic copper or other materials, which has good conductivity, corrosion resistance and tensile strength, with a service life of more than 30 years. There are three different types of copper clad steel grounding rod, among which the threaded type can effectively slow down the oxidation rate of the grounding rod in the underground. It can be widely used in communication industry, power system, building system, military facilities, railway system, etc., especially for the ground engineering with poor environment and high corrosion resistance requirements. It has a broad market prospect.





Golden Electric



Golden Electric

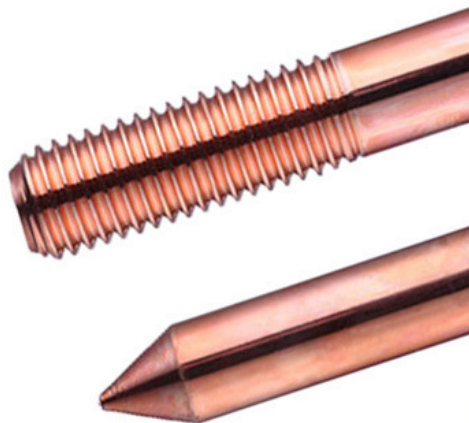



Golden Electric



Golden Electric

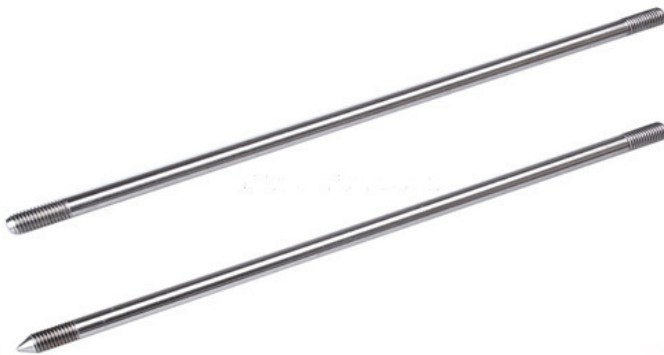



Advantages of copper clad steel material: The copper-clad steel grounding rod has the characteristics of both high conductivity and steel. The copper-clad steel grounding rod is used in general environment and special environment of wet, salt alkali, acid mud, copper-clad steel grounding rod soil and chemical erosion medium. Generally, anti-corrosion treatment is not required. After copper corrosion, the surface is close to the steel, so that it can better integrate into the earth.

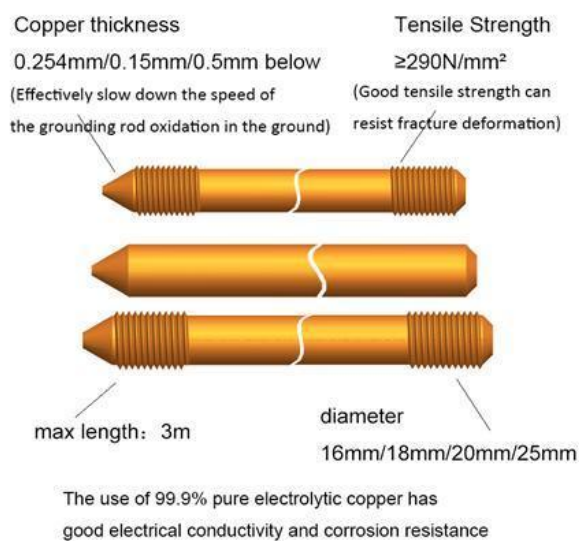

There are three types of products: one point one flat, two thread, thread with a point, in order to adapt to a variety of occasions

### One point one flat earth rod:

The one point and one flat earth bar produced by Balic is the one with the highest overall strength among all the earth bar styles. It can be driven into the ground directly by heavy hammer without other accessories, which is convenient and quick to use and has low installation cost.

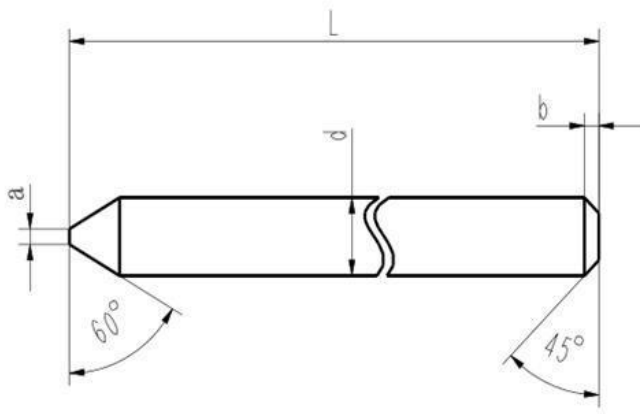

Ground rod dimensions and tolerances

diameter $\Phi$ (mm)	diameter and tolerance d(mm)	length L(mm)	end structure a(mm)	end structure b(mm)
14.2	14.2±0.05	1200	3±1	2.5±0.5
		1500		
		1800		
		3000		
16	16±0.05	1200	3±1	3.0±0.5
		1500		
		1800		
		3000		
17.2	17.2±0.05	1200	4±1	3.5±1
		1500		
		1800		
		3000		
18	18±0.05	1200	4±1	3.5±1
		1500		
		1800		
		3000		
20	20±0.05	1200	5±1	4.0±1
		1500		
		1800		
		3000		
25	25±0.05	1200	5±1	5.0±1
		1500		
		1800		
		3000		

#### Two thread earth rod:

The dual-thread earth rod is equipped with coaxial connector, drive head and drill bit. The length of the cast copper ground rod can be arbitrarily increased. The driving head (connecting bolt) is used to connect the item end, which is used for striking when the rod is deep. The end is connected with a special bit (connecting bolt) to make it easier to hit the bar deep.

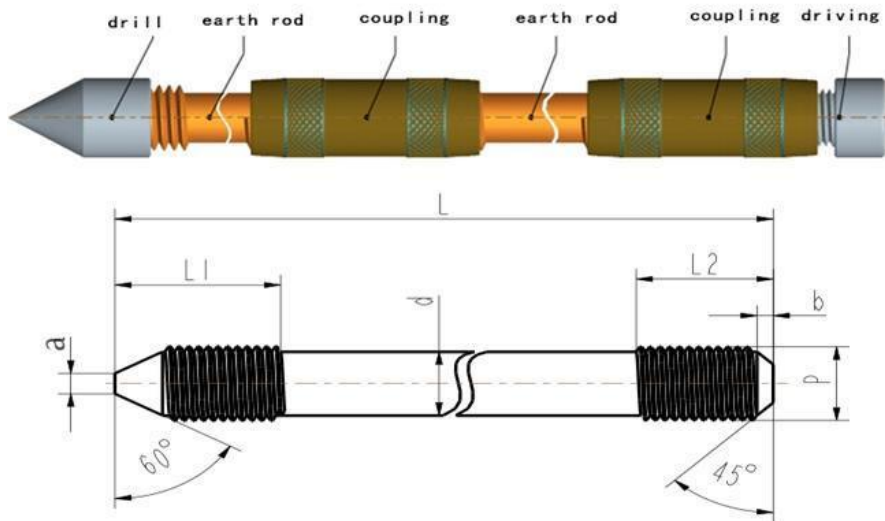

Ground rod dimensions and tolerances

diameter $\Phi$ (mm)	diameter and tolerance d(mm)	length L(m)	screw thread L1(mm)	screw thread L2(mm)	screw thread P(mm)	end structure a(mm)	end structure b(mm)
14.2	14.2 $\pm$ 0.05	1200					
		1500	35	37	M16	6 $\pm$ 1	2.5 $\pm$ 0.5
		1800	(+3,-2)	(+3,-2)	5/8		
		3000					
16	16 $\pm$ 0.05	1200					
		1500	35	37	M18	6 $\pm$ 1	3.0 $\pm$ 0.5
		1800	(+3,-2)	(+3,-2)			
		3000					
17.2	17.2 $\pm$ 0.05	1200					
		1500	35	37	3/4	7 $\pm$ 1	3.5 $\pm$ 1
		1800	(+3,-2)	(+3,-2)			
		3000					
18	18 $\pm$ 0.05	1200					
		1500	35	37	M20	7 $\pm$ 1	4.0 $\pm$ 1
		1800	(+3,-2)	(+3,-2)			
		3000					
20	20 $\pm$ 0.05	1200					
		1500	35	37	M22	8 $\pm$ 1	4.0 $\pm$ 1
		1800	(+3,-2)	(+3,-2)			
		3000					
25	25 $\pm$ 0.05	1200					
		1500	35	37	M27	8 $\pm$ 1	5.0 $\pm$ 1
		1800	(+3,-2)	(+3,-2)			
		3000					

#### Thread with a point earth rod:

Thread with a point earth rod can be connected to two or more ground rods by means of coaxial connector. The ground The depth can be flexibly configured to meet The company requirements of The same project.

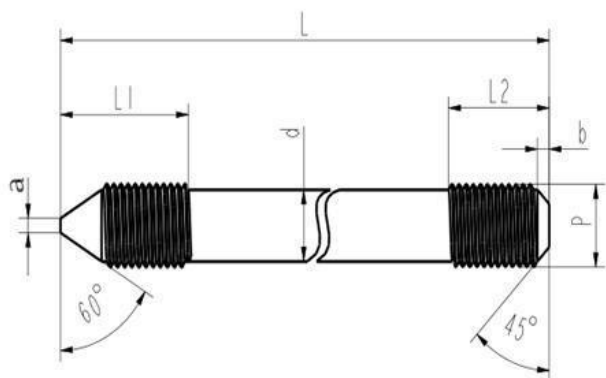

Ground rod dimensions and tolerances

diameter $\Phi$ (mm)	diameter and tolerance $d$ (mm)	length $L$ (m)	screw thread $L1$ (mm)	screw thread $L2$ (mm)	screw thread $P$ (mm)	end structure $a$ (mm)	end structure $b$ (mm)
14.2	$14.2 \pm 0.05$	1200					
		1500	35	37	M16	$3 \pm 1$	$2.5 \pm 0.5$
		1800	(+3,-2)	(+3,-2)	5/8		
		3000					
16	$16 \pm 0.05$	1200					
		1500	35	37	M18	$3 \pm 1$	$3.0 \pm 0.5$
		1800	(+3,-2)	(+3,-2)			
		3000					
17.2	$17.2 \pm 0.05$	1200					
		1500	35	37	3/4	$4 \pm 1$	$3.5 \pm 1$
		1800	(+3,-2)	(+3,-2)			
		3000					
18	$18 \pm 0.05$	1200					
		1500	35	37	M20	$4 \pm 1$	$4.0 \pm 1$
		1800	(+3,-2)	(+3,-2)			
		3000					
20	$20 \pm 0.05$	1200					
		1500	35	37	M22	$5 \pm 1$	$4.0 \pm 1$
		1800	(+3,-2)	(+3,-2)			
		3000					
25	$25 \pm 0.05$	1200					
		1500	35	37	M27	$5 \pm 1$	$5.0 \pm 1$
		1800	(+3,-2)	(+3,-2)			
		3000					

Products Category





Copper Screw Terminal Block

Lug

Connecting Crimping Terminal Cable



Circuit Protector with Over Circuit Breaker



Screw Fixed Barrier Terminal Block

#### Packing & Delivery

Packaging Details: woven belt+Iron pallet+container

Lead time:

Quantity(pieces) 1 - 1000 >1000

Lead time (days) 15 To be negotiated

## FAQ

Q1: Are you a factory or trading company

A1: We are a factory, we can guarantee our price is first-hand, very cheap and competitive.

Q2: How does your factory do regarding quality control?

A2: All the products will be 100% checked before the shipment

Q3: When can I get the price?

A3: Usually we quote within 24 hours after we get your inquiry.

Q4: How could I get a sample?

A4: if you can not buy our product in your local area, we will ship a sample to you. You will be charged a sample price plus all related shipping costs. Express delivery charge depends on the quantity of the samples.

Q5: What is the price of shipping?

A5: Depending upon the port of delivery, prices vary.

**Any more query please contact with us, thank you!**



**Guangzhou Golden Electric Co., Ltd.**



008618998498109



eva@china-golden.com.cn



chinagoldene.com

Building 4, Self-edited Building, No. 728, Kaichuang Avenue, Yunpu Industrial Zone, Huangpu District,  
Guangzhou city, Guangdong province, China