



Cable End Termination Square Crimp Terminal Connector with Copper Lug and Pure Copper

Our Product Introduction

Basic Information

- Place of Origin: China
- Brand Name: Golden Electric /OEM
- Certification: ISO 9001, ISO 9000, ISO 14001, ISO 14000, ISO 20000, OHSAS/ OHSMS 18001, IATF16949
- Minimum Order Quantity: 1
- Packaging Details: Carton/Pallet
- Delivery Time: Peak Season Lead Time: more than 12 months Off Season Lead Time: within 15 workdays
- Payment Terms: LC, T/T, PayPal, Western Union
- Supply Ability: 5000/Month



Product Specification

- Surface Finish: Tin-Plating
- Transport Package: Ocean Freight
- Specification: Different Sizes And Specifications
- Trademark: Golden Electric Or Customize
- Origin: China
- HS Code: 7419209000
- Supply Ability: 5000/Month
- Type: Lug, Crimp Terminal
- Material: Copper, T2 Pure Copper
- Species: Terminal
- Production Process: Welding
- Shape: Square
- Model Number: Sc-50-8
- Customization: Available | Customized Request



More Images



for more products please visit us on chinagoldene.com

Product Description

Company

Profile

GoldenElectricCo., Ltd.

is professional make of Electrical products .Such as distribution box, waterproof plug, socket, wall switch, waterproof plastic ,Aluminum box ,Changeover Switch and disconnecting switch,MC4 Connector.isolator switch.fusebreaker.distribution box,PV combiner box .surge protector, Indicatorlamp,Solar Charge Controller,Industrialplugandsocket,BusbarInsulator,Meter Socket,Wind Turbine, Terminal Block,Solar product and so on. all products comply with IEC, A S/NZS standard. passed CE, IP66, ROHS certificates.at present we have exported to many countries and have serve these customers with professional electrical solution.

Product Description

Material:	T2 pure copper	Conductor/cable applicable:	50mm2
Apperance:	Silver	Tin-plating:	Corrosion protection
Stud hole diameter:	8.5mm	Inner diameter of tube:	9.6mm
Packing unit:	Poly bag + box + carton		
Equipment:	Punching machine, electroplating system		
Application:	Cable/wire end crimping		





Golden Electric



Golden Electric

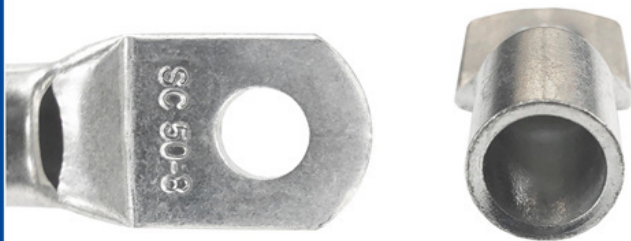



Golden Electric



Golden Electric





Golden Electric



Golden Electric





Golden Electric



Golden Electric



Products Details



Golden Electric



Dimension: mm

Model $D \pm 0.2$ $d \pm 0.2$ $G \pm 0.3$ $L \pm 1.5$ $L_1 \pm 1$ $W \pm 1$ ± 0.5 Tube Thickness
 SC 50-8 12.5 9.6 2.8 45 17 18 8.5 1.45

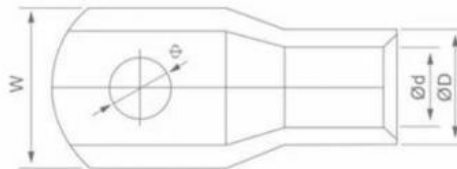

Electroplated
Smooth surface
Protecting against
corrosion



Model mark
Inspection hole



Uniform
thickness

Products Category



Golden Electric

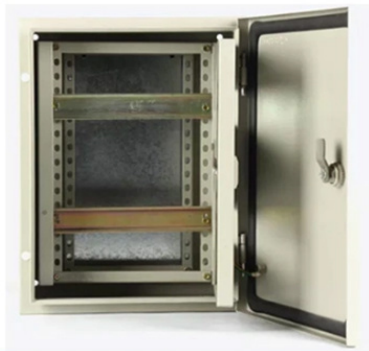

Surface Model MCB Panel Box Distribution Board



Golden Electric



Weatherproof Waterproof Electric Socket Switch



Golden Electric



13A 2Gang Switch 1Gang Industrial Socket



Golden Electric



Low Voltage Current Power Transformer

Packing & Delivery

Packaging Details : Poly bag & carton

Picture Example:



Lead time:

Quantity(pieces) 1 - 50000 >50000

Lead time (days) 15 To be negotiated

FAQ

Q1: Are you a factory or trading company

A1: We are a factory, we can guarantee our price is first-hand, very cheap and competitive.

Q2: How does your factory do regarding quality control?

A2: All the products will be 100% checked before the shipment

Q3: When can I get the price?

A3: Usually we quote within 24 hours after we get your inquiry.

Q4: How could I get a sample?

A4: if you can not buy our product in your local area, we will ship a sample to you. You will be charged a sample price plus all related shipping costs. Express delivery charge depends on the quantity of the samples.

Q5: What is the price of shipping?

A5: Depending upon the port of delivery, prices vary.

Any more query please contact with us, thank you!



Guangzhou Golden Electric Co., Ltd.



008618998498109



eva@china-golden.com.cn



chinagoldene.com

Building 4, Self-edited Building, No. 728, Kaichuang Avenue, Yunpu Industrial Zone, Huangpu District,
Guangzhou city, Guangdong province, China